

INFORMATION ABOUT

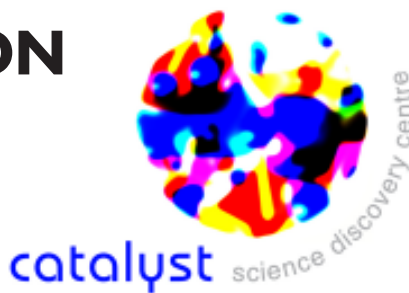

THE LAYOUT

Catalyst is housed within five floors. There are 3 exhibition floors, an education centre containing toilets, cloak-rooms and the lunchroom, a cafe, shop and reception area. The following floor plan will help you locate your position in the building. Please note there is no public access to the conference rooms on the second floor and the administration department on the third floor.

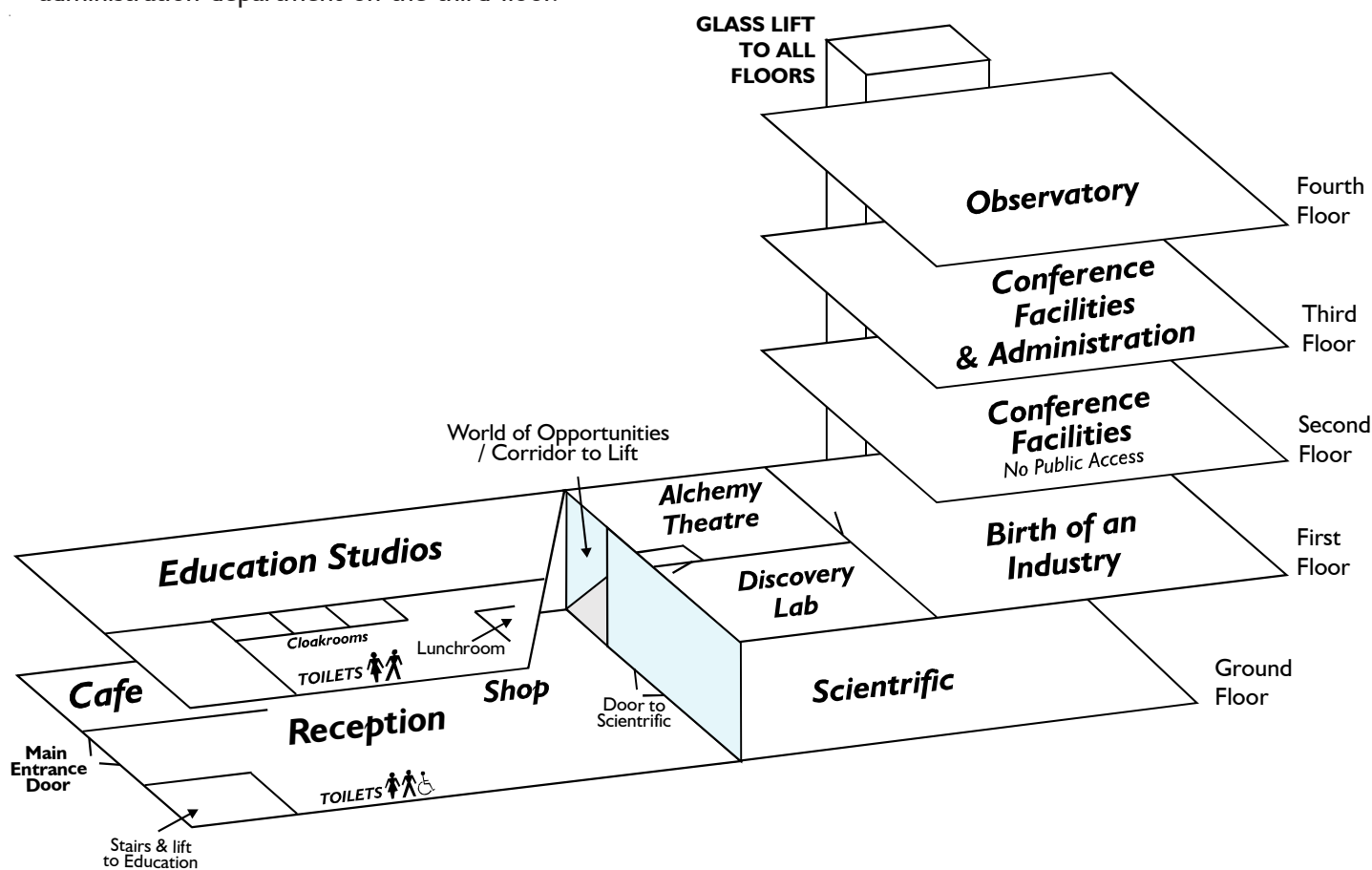

Exhibit areas include:

Scientific (ground floor)

Fun, hands-on exhibits and activities about making and using chemicals.

Birth of an Industry (1st floor)

A look at the history of the chemical industry. This exhibit area begins with early civilisation, looking at the use of natural pigments, dyes and new technology concerning the use of materials.

Observatory (4th floor)

Ride in the glass lift to the fourth floor and experience the spectacular views. Find out about land use and recycling.

Education Centre (1st floor - only accessed via main Reception)

Pre-booked school workshop activities take place in the Education Studios or the **Catalytic Discovery Lab**.

Alchemy Theatre (1st Floor)

Some science shows are delivered in the Alchemy Theatre, the entrance is on the first floor adjacent to Birth of an Industry.